

Loading Arms

Applications:

- Used in the transfer of liquids and dry bulk in refineries, chemical plants, rail terminals, truck terminals, tote and drum filling and food industry

Sizes:

- 2", 3", 4" and more upon request

Materials:

- Various materials available including: hardened carbon steel, 316L stainless steel and aluminum
- Seals: Buna, EPDM, FKM A and B, PTFE, Baylast and more on request
- Steel counterbalance housing

Features:

- Three options for sealing swivels: O-ring, V-ring and Split Flange
- Engineered with easy service in mind
- Wide variety of end configurations available

Torsion Spring Counterbalance

- Ball screw adjustment mechanism for easy and safe adjustment
- Multiple spring rates available for different load requirements
- Multiple grease ports for ease of service

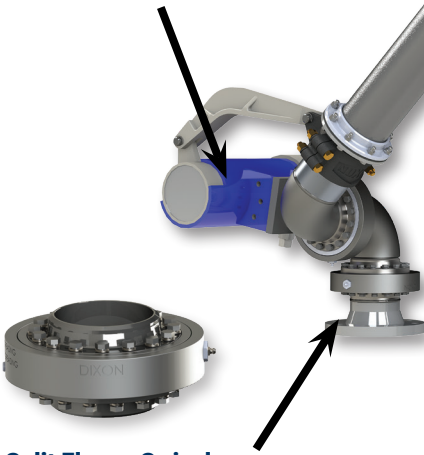

Split Flange Swivels

- Bearing pack design allows easy seal change without removing the ball bearings.
- Simple maintenance: remove one nose piece, replace seal pack, and reinstall with little down-time
- Wide set bearing race for higher moment loads
- Compact design for low profile applications

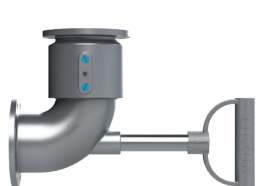

Style 30,
long/ short radius



Style 40

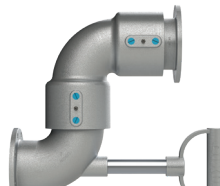

Style 50

TTMA Flange Extensions

- Used to connect an API coupler to a loading arm
- Adds a 6" space to allow for clearance between the loading arm and the tank truck
- Colour coded for product identification
- Aluminium, powder coated aluminium



Loading Arm Swivels

- Heavy duty D style shovel handle to guide the API load coupler onto the adapter
- TTMA flanges on both ends
- Long radius elbow improves the flow into the API load coupler and provides spacing between the load arm and the tank truck
- Can be used with flange extensions

API Fittings

Couplers are completely modular so they can be built with various face seal combinations to be compatible with different alternative fuels, performance levels and applications

**EXCLUSIVE
5-YEAR
MECHANICAL
WARRANTY***

5500 Series API Coupler

Application

- Suitable for rail car and tank truck loading or unloading

Features

- Locking five-cam design provides easy alignment and tight connection
- Replaceable nose seal can be changed without removing coupler from loading arm
- Nose seal design tested to **450 PSI** without seal ejection
- Fully interlocked collar prevents fitting from opening when disconnected and from being disconnected while opened
- 4" TTMA inlet mounting flange connection
- Two piece break-away design, ball-end handle for easy and comfortable operation to allow for continued operation should the handle to sheared away
- 10 stainless steel coiled springs put more pressure on the nose seal-to-truck API adapter to help prevent leaks.
- No special tools needed for maintenance



coiled springs

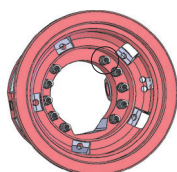
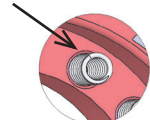

sleeve lock

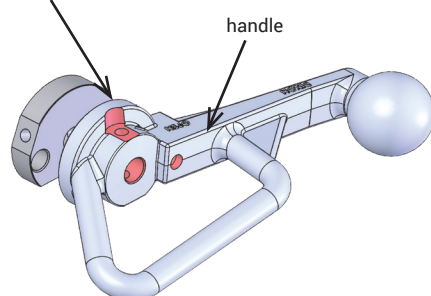

handle

5500 seal design

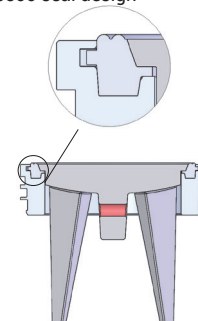

API Load/ Unload Adapter

Application

- Combined with couplers, these valves are suitable for rail car and tank truck loading or unloading

Features

- When used with an API coupler (above) can be used as a high volume dry-disconnect connection
- Unique fluid flow sight level on load only models
- Chemical resistant crank seals
- Rotate nose for a new connection surface
- 4" TTMA inlet mounting flange connection
- Ergonomically curved handles operate on a short 62° degree stroke
- Can be rebuilt without removing from tanker

Load/Unload



Hose & Hose Assemblies

Dixon offers a range of suction and discharge hoses and hose assemblies designed for use on plant or road/rail tankers. Hose construction is exceptionally flexible for ease of hanging yet remains robust, hard wearing and cost effective.

Rack Monitor

Application

- Installed on the gantry to control the loading process of petroleum fuels or other hazardous liquid into cargo tanks

Features

- Automatically detects and switches between 2-wire or 5-wire type sensor operation
- Compatible with analog 2-wire thermistor type sensors
- Redundant relay outputs prevent single point failures
- Data management via RS485 port
- Wireless bypass key system
- Ground verification
- Reads trailer identification modules

Approvals

- Meets API RP1004 and EN13922 standards
- Suitable for Class I, Division 1, Group CD and Class I, Zone 1, Group IIB



Rack Monitor System

Break-Away & Dry Disconnect Couplers

Application

- Safety Break-Away couplings are designed to minimize spillage and damage associated with accidental drive away and pull away incidents.
- Dry Disconnect Couplings are designed for quick and spill free connection of hoses and pipelines

The range includes:

- Safety Break-Away
- Dry Gas
- Dry Quick Disconnect
- Dry Break Cam & Groove
- Dry Aviation
- Bayonet Style

Dixon are able to recommend the best type of connection to fulfil your petrochemical requirement.

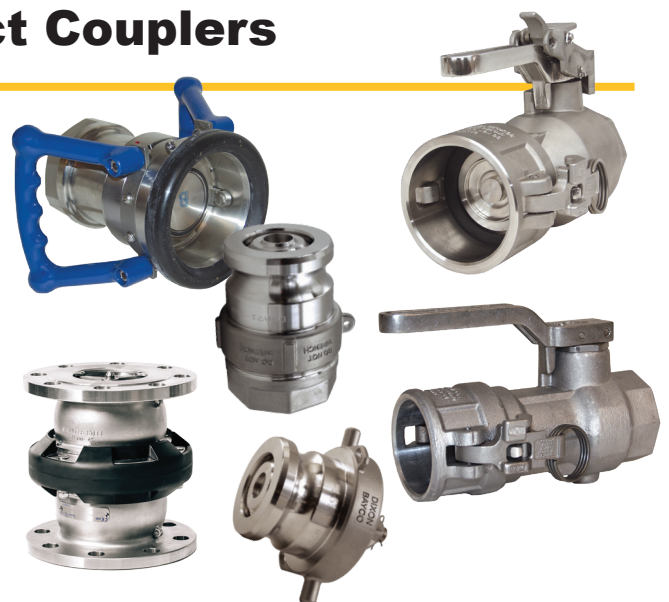

Petroleum Products & Overfill Prevention

Overfill Prevention Probes

Application

- Overfill detection sensors are intended to detect a pending overfill condition inside the fuel tank compartment.

Features

- Manufactured in accordance with EN13922
- Unique prism sealing design prevents product and vapour entering the electronics and causing probe failure
- Probes are available in 7", 12" & 18" lengths. Custom lengths available
- ATEX Approved
- Fully compatible with installed industry standard rack monitors
- Option: Pre-wired and factory tested with Plug-n-Play cabling and plugs



Overfill Prevention Sockets

Application

- Sockets allow for the transfer of the electronic signal from the terminal control monitor to the tanker.

Features

- Socket options include 6 pin, 3 J slot and 10 pin, 4 J slot
- Sockets can include a brake interlock to prevent drive away, vapour recovery interlock or both
- Patented nose ring that permits replacement without the need to disconnect the wiring.



FT555 Truck Tester

Application

- Fully automatic truck tester capable of testing API 5 and 2 wire systems

Features

- One man "wet test" feature of the FT555 will sound an audible alarm when probe is wetted
- LCD screen displays the final test results and a pass/fail indication for easy rapid testing of the overfill system
- API plug can be reconfigured for both socket options



Ball Nozzles for Bulk Delivery

Application

- Delivery of bulk liquids

Features

- Hardened chrome steel roller balls and hardened carbon steel ball race provide long service life.
- Uses a full port ball valve for high flow rate
- Unique swivel design permits low temperature operation without leakage around the O-ring seals
- Internal flow path is designed to provide low pressure drop across the nozzle. Lower pressure drop permits higher flow rates at lower pressure



Replacement Parts

Dixon offer a complete range of replacement parts for your overfill systems.

Petroleum Tanker Products



Item	Description
1	3" Sequential compartment vent valve
2	3 " Dump Vent
3	1.25" PV vent valve
4	ADR Man lid
5	500mm Aluminium neck ring
6	2 Wire optic plug & play probe
7	4" Foot valve low profile
8	4" Foot valve standard profile

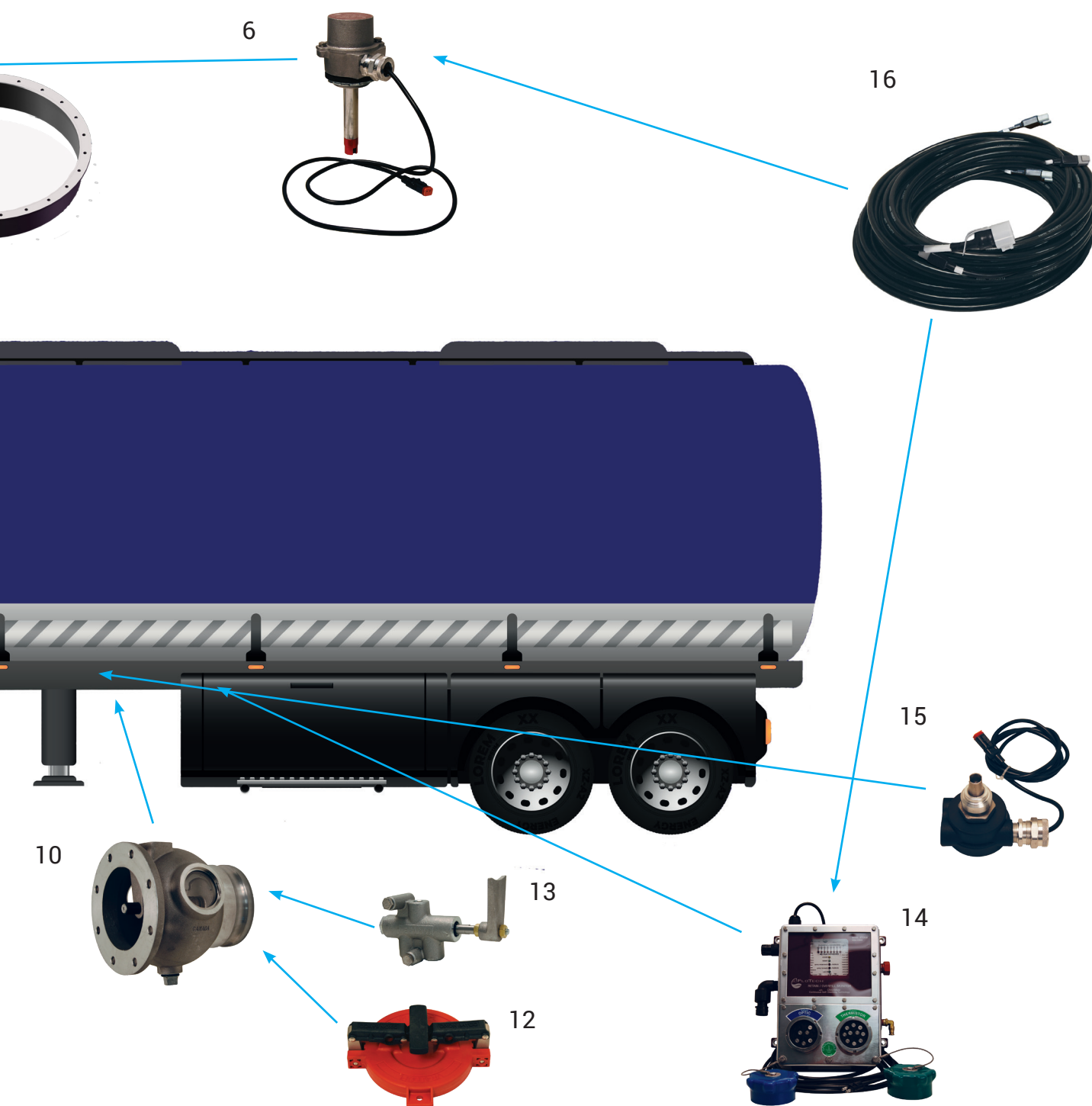

Item	Description
9	4" API valve
10	Vapour recovery valve
11	Cap for API valve
12	Cap for vapour recovery valve
13	Interlock for vapour valve
14	Checkmate monitor
15	Retain sensor

The Petrochemical Lifecycle

The oil and gas industry is broken down into three key sectors: upstream, midstream, and downstream. Exploration and production, collection and transportation, and refining and purification all come with unique challenges. Dixon manufactures and supplies a wide range of fluid transfer solutions including API certified products, zero emission valves, no-spill couplings, and safety breakaway fittings.



EXPLORATION & PRODUCTION	REFINING	TERMINAL TO RETAIL
<ul style="list-style-type: none"> • Low Pressure System Products • Frac Fittings • King Crimp System • Hammer Unions • Control Valves • Permanently Swaged Couplings • Tank Truck / Railcar Fittings • Hose Assemblies 	<ul style="list-style-type: none"> • Dry Break Couplings • Cam & Groove • Dry Disconnects • Ground Joint Systems • Valves • API Fittings 	<ul style="list-style-type: none"> • Overfill Protection • Loading/Unloading • Adapters • Vapour Elbows • Swivel Joints • Tank Truck & Rack Fittings • Nozzles • Loading Arms • Rack Monitor • Mechanical Components

Reliable terminal and tank truck solutions to keep you moving

Dixon is a premier manufacturer and supplier of fluid transfer products for a wide range of applications. As a leading solutions provider Dixon are always looking to improve and extend their range to offer new and innovative products to the fuel distribution market.

With an unsurpassed reputation Dixon is committed to providing value added services, superior customer service, technical support and training to the industry. With our global distribution footprint Dixon can

efficiently service our customers with the right goods at the right time.

Already established as a leading manufacturer of petroleum tanker fittings and the FloTech™ Overfill Prevention systems; Dixon now offer a full range of Fuel Distribution products for use in the downstream market including fuel terminal, fuel depots and skid units where safety, ease of use and efficiency are key factors



Customer Service: +44 (0)1772 323529
Email: sales@dixoneurope.co.uk



The Right Connection®